



Building His Church

FAITH PROMISES
2008-2011



Grace
Evangelical
Presbyterian Church

3312 Calvin Drive
Lawrence, Kansas 66049
785.843.2005



Building His Church

“You will be enriched in every way for all your generosity,
which through us will produce thanksgiving to God.” — 2 Corinthians 9:11

From Our Pastor

Dear Grace Family,

This is a very important time in the life of our church. For many years we have sensed the growing need for more space to carry out the ministries God is calling us to at Grace.

The readiness assessment we conducted a few months ago confirmed that a vast majority of our church family noted the immediate need for more space to teach and disciple children and adults, as well as the desire to provide a space that will enhance our corporate worship. Indeed, our elders believe now is the time to make a decision about a building expansion that will enable us to better serve God and our community.

Though the **Building His Church** effort is our way to determine the funds available for such a building expansion, it is more than that. It is really about our life together and the mission that we share.

Thus, I ask that each of you prayerfully consider making a faith promise commitment that will enable us to build additional space for more effective ministry both now and in the future. Please know that every gift is important, regardless of the amount, and is an expression of God's grace to us and will result, we trust, in thanksgiving to Him.

Our desire in **Building His Church** is that God be glorified as we worship Him and make Him known. Please pray about your faith promise, decide what God would have you do, and bring your faith promise card to church on December 7. Thank you for your heart for God and your faithfulness to His call.

Blessings,

Bill Vogler

rch

From Our Building His Church Co-Chairpersons

Dear Grace Church Family,

This is an exciting time in the life of our church, and we are privileged to write to you about the **Building His Church** project. God has continued to bless our church with our present facility, pastors, and ministries, and we look forward to seeing what God plans to do as our congregation moves forward.

We have been given the task of overseeing this effort to fund the expansion of our facility. We are excited about that assignment and take it seriously. Each member of this congregation is a stakeholder in the future of Grace Evangelical Presbyterian Church. Whether you have been attending for several years, or if you recently joined the Grace family, we all want this church to be here for the present congregation and for those who will follow us.

God has blessed this church many times over, and we want to share those blessings with many others in this community.

We ask that you pray and reflect on what Grace Evangelical Presbyterian Church means to you and your family. For many of us, a gift of this importance will have a lasting impact on our own faith journey and that of our children and community.

Please join us in making your three-year faith promise on December 7, 2008, Commitment Sunday. We thank you for your generosity to partner with us in **Building His Church**.

Warmly,

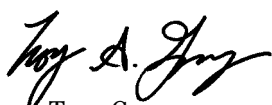
Troy Gregory

Carol Rau

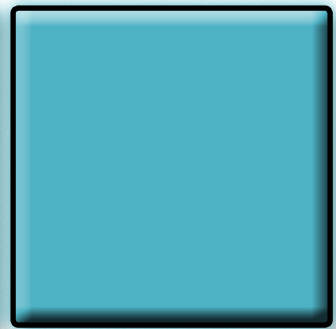



Build

Our Expansion Goals

We know that to build all the components needed for our expansion – a sanctuary, education space for adults and youth, fellowship, storage and office space – we will need approximately \$4.5 million to \$6 million. Based on the faith promise commitments made to **Building His Church**, our elders will recommend to the congregation a building scenario and the amount we might need to borrow. The consultants helping us with the project indicate we can expect to raise \$1.3 million to \$2.8 million. Therefore, the closer we come to the \$2.8 million goal, the closer we'll be to building all the components. Otherwise, we will approach the expansion in phases.

Our Prayer

Our Father and our God,

we praise You for who You are.

You have provided for us through Your sovereign grace: this church, this fellowship of Your people, and especially our eternal salvation through the blood of Jesus Christ.

You have blessed us and sustained us, giving us: a place to worship, a growing community of Christ-minded believers, and a desire to reach the lost for Christ – and all for Your glory alone.

We humbly acknowledge that ALL good gifts come from You.

We confess we are all sinners led astray and so we ask Your direction and wisdom, Lord, concerning the ministry and facilities You desire us to consider building. We desire that You will be done.

Please give us wisdom in finances, humility in planning, and graciousness in thought and compassion for one another during this process.

Grant that we may joyfully give from the abundance You supply, to build a house for Your holy Name, that the light of the gospel of the glory of Christ may shine through Your Church.

And we ask You to direct us Lord, in all our doings with Your most gracious favor, and further us with Your continued help; that in all our works begun, continued and ended in You, we may glorify You, and finally by Your mercy, obtain everlasting life, through Jesus Christ our Lord.



The renderings here depict possible phases for expansion to our facility including: **worship space, adult and youth education space, and increased narthex/fellowship space.**

ding His Church

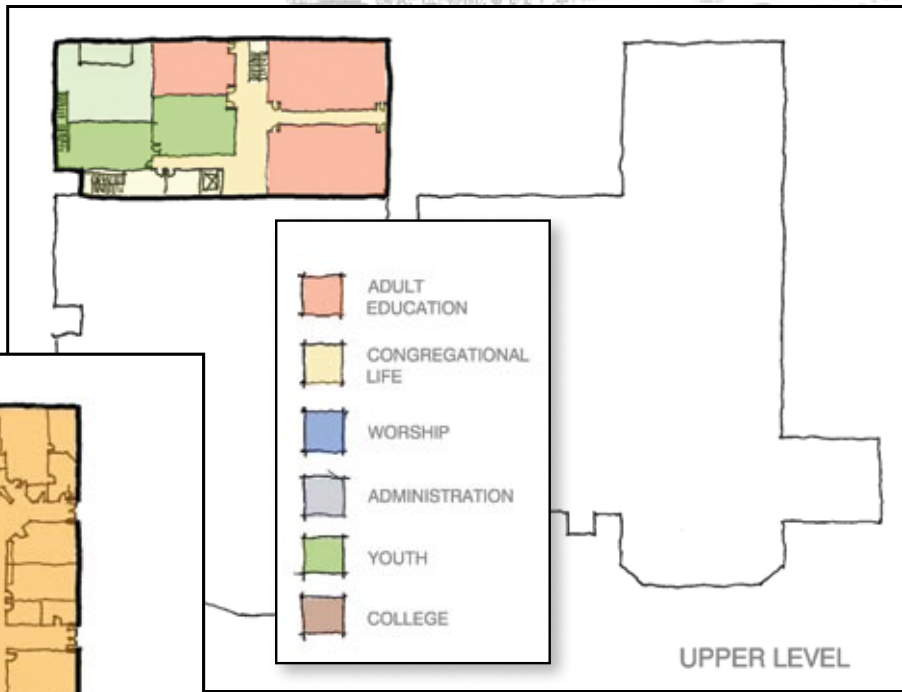

Your decision to give

We know that giving to this project is a very important decision, for we're asking that you give over and above your regular giving. Thus, we continue to encourage you to pray about your faith promise gift before deciding what you intend to give. Moreover, we ask that you consider the following:

- Recall the blessings God has given to you, remembering that everything we have belongs to God and our role is to be a good manager of His resources.
- Remember the impact that can be made for Christ through your sacrificial gift. Our church has a unique calling to serve God and the community in Lawrence.
- Bear in mind that every gift, regardless of size, will be an important contribution to God's work through our church.
- Discuss your family's participation with all members of your family and what it will mean to each of you.
- Pray to discern what sacrifice God is asking of you in this process. Pray also for the elders and church staff for wisdom and strength as they lead the church through this expansion.

Remember, all gifts to the Building His Church expansion effort are important. We would love to see 100 percent of our members and regular attendees support this effort. We know there will be a sacrifice to give to this building expansion effort. Thank you for your support of our church.



Questions & Answers

ABOUT YOUR DECISION TO GIVE

How much should I give?

This, of course, is between you and God. We encourage you to go to the Lord in prayer and discern from Him what He would have you give. You may find it helpful to use the accompanying charts to get a picture of what a weekly or monthly gift of two or three percent of your income would mean over the course of three years. Regardless of the amount you decide to give, all gifts to Building His Church are important and will help us fulfill our mission to spread the love of Jesus.

THREE-PERCENT GIVING CHART

Annual Income	3% Annual Gift	Total 3-year gift	Weekly Donation	Monthly Donation
\$100,000	\$3,000	\$9,000	\$57.69	\$250.00
\$75,000	\$2,250	\$6,750	\$43.27	\$187.50
\$50,000	\$1,500	\$4,500	\$28.87	\$125.00
\$25,000	\$750	\$2,250	\$14.42	\$62.50

TWO-PERCENT GIVING CHART

Annual Income	2% Annual Gift	Total 3-year gift	Weekly Donation	Monthly Donation
\$100,000	\$2,000	\$6,000	\$38.46	\$166.67
\$75,000	\$1,500	\$4,500	\$28.87	\$125.00
\$50,000	\$1,000	\$3,000	\$19.23	\$83.88
\$25,000	\$500	\$1,500	\$9.62	\$41.67

Is my faith promise commitment to Building His Church in addition to my annual giving?

Yes. A faith promise gift to Building His Church is in addition to regular annual giving to Grace's general ministry. We are asking you to consider making your three-year faith promise gift on Commitment Sunday, December 7th. These gifts will be devoted to expanding our facilities.

Are there other ways I can give?

Yes! Many people may give gifts of stock, mutual fund shares, or other property which can then be used to support the expansion effort. You may also realize additional tax benefits by making gifts of property. If you would like to make this type of gift, please contact Grace's operations administrator, Bob Woods, at 785-843-2005.

When should I make my faith promise gift and first contribution?

December 7 is our Commitment Sunday. We ask that you bring your faith promise card to worship on that day. If you will not be at church on December 7 you can use the envelope provided to mail your faith promise card to the church, hand-deliver your gift to the church office, or drop your faith promise card in the giving boxes located at the back of the sanctuary the week before. While you can begin making contributions immediately, the church welcomes your contributions when you are best able to begin fulfilling your faith promise commitment.

How often do I make a contribution toward my faith promise gift?

How much you give and when you give is up to you. Many participants give a portion of their faith promise each week or month. Some give on a quarterly or annual basis. Others make a one-time contribution. You can select a donation schedule that works best for you. The Building His Church faith promise giving period runs through November 2011.

Building His Church Ministry Teams

Senior Pastor

Bill Vogler

Co-Chairpersons

Troy Gregory
Carol Rau

Prayer Team

Debbie Andrews, Anita Barnum, Luanne Coats, John Cook, Chris and Ken Golden, Jennie Jewell, Lorel Lewis, Barbara Stephens, Harris Tate, and Matt and Karla Westphal

Events Team

Larry and Dea Birmingham, Rhonda Cook, Dennis Jewell, Lori Lange, Cecilia May, April Phillips, Kelli Pratte, and Lindsey Pratte

Thanks Team

Don Adema, David Franklin, Lisa Gaston, Kim Haig, Dennis Meier, and Lorraine Wells

Youth Team

Theresa Bari, Tyler Clements, Rebecca May, Scott Rask, and Peris Wanjiku

Ambassador Team

Rick and Amy Ballinger, Cliff Cogger, Steve Flory, Steve and Wanda Haney, Kari Heide, Mark and Anne Jarboe, Steve and Jill Jordan, Jon and Kristina Marburger, Jeff and Pricilla McPheeters, Walter Murphy, and Larry and Barbara Swinson

Communications Team

Angela Jacobson, Rick Pratte, Kristi Reimer, Jeannie Robinson, Tom Stofac, and Kari Woods



Our History



Under construction in 1995

1988-1990

On June 5, the first service of what would become Grace Evangelical Presbyterian Church meets at Deerfield Elementary School. Bill Vogler called as Grace's first pastor. Grace constituted as an Evangelical Presbyterian Church, and first elders are elected.

1991

Current nine-acre site purchased for \$90,000. Master building plan includes a sanctuary, gymnasium-fellowship hall, children's area, youth and adult classrooms, offices, and kitchen.

1995-1997

Construction begins on the first building phase: general-purpose space for worship, fellowship, and recreation; temporary office space; and a small kitchen. Project costs \$1.1 million. The first service is held in the new facility in December 1995. A second worship service is added in 1996 to accommodate significant growth — attendance increases nearly 250 percent in 1996 and 1997.

1998

Second building phase begins to provide for children's ministry, adult education, and added staff; construction completed by December 1998. Project costs \$1 million.

1999

Commercial-grade kitchen completed and 159 additional parking spaces added to alleviate parking lot congestion and provide additional parking for the future sanctuary. Worship attendance increases by about 140 people.

2001

Sunday worship attendance averages 885 and levels off through present time.

2008

Church appoints a building team, contracts with Treanor Architects, and hires The Church Development Foundation, www.TCDF.org, to assess space needs and financial capacity for possible renovations and additions.



Left: Two of Grace's founding members chat in the narthex of the new building